

BelFone

www.belfone.com



BF - OG200
FM Radio

Notice to the user

Government law prohibits the operation of unlicensed radio transmitters within the territories under government control.

Illegal operation is punishable by fine or imprisonment or both.

THANK YOU!

Since 1989, BelFone has been always engaging in research and exploration of radio communications technologies, in order to lead intelligent technologies in the industry. We make every effort to research and design products according to modern complicated communications environment and we offer complete and customized communication solutions to clients. Our products will satisfy you because of its excellent performance and outstanding communications strength. No matter what field you are in, you will be satisfied with the radio

This manual is applicable to
UHF FM transceiver model: BF-OG200

Warning!

- ◆ In inflammable and explosive environment (gas station, gas station, textile factory and other areas with more combustible gas and dust), please turn off the power supply of the walkie-talkie.

Precautions

It's important that the operator is aware of and understands hazards common to the operation of any radio. Please observe the following safety precautions to prevent radio damage or personal injury. The following precautions shall be observed during operation, service and repair of this radio.

◆The recommended usage rate is 1 minute for TX and 4 minutes for RX, when the radio is used for transmission for many hours continuously, the radiator and chassis will become hot;

◆Don't leave the transceiver in direct sunlight for a long time, don't place the transceiver on extremely heat, damp, dusty area, and don't put it on unstable surfaces;

◆When restriction or warnings are posted regarding the use of radio devices, please obey the regulation and turn the transceiver power off;

◆Use of the radio while driving may be against traffic laws, please avoid using it ;

◆If you notice any problems on the radio, please turn off at first. Then contact with local dealer. Do not modify this radio unless instructed by this manual or refer service to a qualified licensed or certified technician only;

◆If you want to use the machine for secondary development, please contact with BelFone's technical engineer or dealer for technical assistance;

◆Please keep the surface of radio clean and dry, clean the radio using a cloth moistened with clean water and a mild dishwashing

Supplied Accessories

Notes: The accessories listed below are covered by BelFone dealer, authorized BelFone agents or factories.

After carefully unpacking the transceiver, identify the items listed in the table below. If any items are missing or have been damaged during shipment please contact with dealer immediately.

Accessories



Strap



Belt Clip

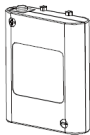

Li-ion Battery

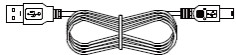

USB charging Cable



Earphone

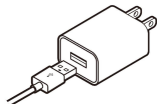

Power Adapter

Interphone accessories installation



Take out the transceiver

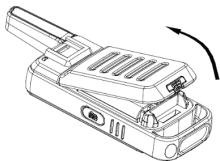

Open the battery cover

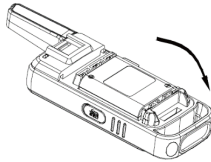

Push the battery into the battery jar, match the guides of the battery with the corresponding grooves on the back of the radio, press down the battery until a click is heard to lock it in place.

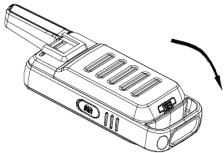

Close the battery cover



Mounting the belt clip

Note: Don't attach/remove the battery if the radio turned on

Interphone battery

installation

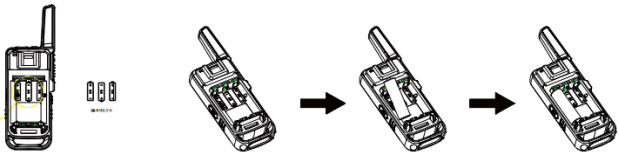

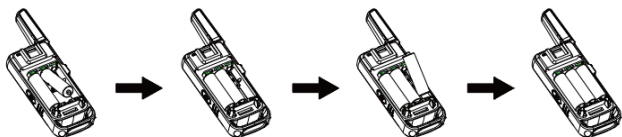

- If you are using AA battery or No. 5 battery, please install the battery strictly according to the direction on the back of the radio, so as not to reduce the life of the contact by mistake.
- Suggestion: For better user experience, please choose original Li-ion battery.

Interphone battery

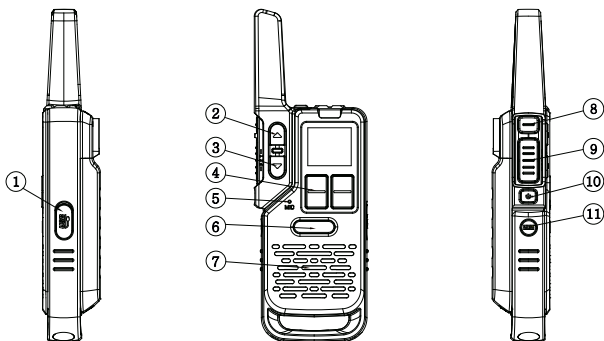

1	Micro-USB Charge Jack	7	PPT key
2	↑/Increment Button	8	Quickly Team Building
3	↓/Decrement Button	9	PPT key
4	Function Keys	10	Power On/Off Button

5	Microphone(MIC)	11	SOS Button
6	PPT key		
function keys	Including 【MENU】 【OK】 【Flashlight】 【Ringtone】		

Icon Indicated

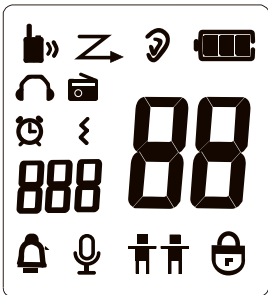

	Launching		Plug in earphone		RingtoneFM Radio
	Receiving		FM Radio		VOX On
	Scanning On		Stopwatch		Quickly Team Building
	Monitoring		The Countdown		Join The Team Quickly
	Battery Capacity		Vibration Mode		Keyboard Locked

Introduction to Functions and Operations

Press [MENU], then press [↑/↓] to select the function, and the blinking function icon indicates the function that is currently in use. Press [OK] to confirm the operation, and the function icon will be blinking to always on ; No function icon indicates when a function is not enabled.

1. Power on/off

Long press the power button, the walkie-talkie will make "Beep" sound, and the host self-check screen will show "L" after starting up.

Under the power-on state, long press the power button, the walkie-talkie will make a "beep beep" sound to close.

2. Transmit/receive

Press and hold down the PTT key or TALK button to launch, speak to the MIC.

Release the PTT key to receive.

3. Double Channels Monitoring

In conventional standby mode, the terminal monitors two waiting channels (primary channel + secondary channel), and PTT Key and TALK button key transmit to the primary channel by default.

4. Main channel switch

In standby mode, the large number on the screen indicates the current main channel number, and the small number indicates the current main channel subtone. In standby mode, press [OK], the channel number flashes, select the channel, press [↑/↓] to lock the channel and enter the channel subtone setting, press [↑/↓] to switch CTCSS/CDCSS (serial number 0 means no CTCSS/CDCSS), press [OK] to confirm.

Long press 【 ↑/↓ 】 can quickly select channel number.

5. Sub-channel switch

By operating menu, select the second channel operation function, the screen print display "2 ch"), the characters show the current deputy channel number,

press [OK] to enter, channel number, according to 【↑/↓】 switching channels at this time, press the [OK] key lock channel, small digital display number represents the tone at the same time, press the 【↑/↓】 key to adjust the tone, press [OK] to complete the tone setting, and automatically return to the standby interface.

6. CTCSS and CDCSS

The small number on the screen represents the CTCSS/CDCSS (mute code number) of the current channel.³⁸ analog CTCSS +83 forward digital CDCSS +83 reverse digital CDCSS are available (0-204 optional, 0 for no subtones). Long press ↑ or ↓ key to quickly select CTCSS/CDCSS number. Note: it is normal for some forward digital CTCSS/CDCSS and reverse digital CTCSS/CDCSS to communicate.

7. Ending sound elimination

It supports ending sound elimination when subtone is on, and it supports to send 55Hz frequency to turn off the other speaker at the end of transmission.

8. Scanning

Through the menu operation, select the scan function (scan icon on the broken code screen ) , press [OK] to enter/exit the scanning mode and scan all the configured channels. When a voice signal is scanned in a channel, the loop scan is continued after the end of receiving and after 3 seconds in the channel.

Before the scanning function is turned off, the scanning icon on the screen should always be on, and press the PTT key within 3 seconds to specify the reply to the active channel.

9. Monitor

Through the menu operation, select the monitor function (monitor icon is displayed on the broken code screen ) , press [OK] to confirm that the monitoring function is on/off, and continue to monitor [main channel] selected by default.

10. Keyboard lock

In standby mode, long press [OK] keyboard lock key to open/unlock keyboard operation (lock icon on broken code screen ) , SOS Key, PTT Key and TALK button are not affected by keyboard lock and can be operated at any time.

11. Volume control

In standby mode, directly operate the button [\uparrow/\downarrow] to adjust the volume level of the speaker/headset. During operation, according to the current volume, the speaker/headset has "Beep" feedback of corresponding volume level, and the volume of 1-8 levels can be adjusted.

12. Quickly team building

initiate

In standby mode, long press the [Quickly Team Building] button on the left side of the machine for 3 seconds to start the "Initiate fast Team" icon on the screen  Lights up. At this point, send the current [main channel] and [sub-channel] channel information to the surrounding loop, and long press the [Fast Team formation] button on the left side of the fuselage again to end the initiating team formation and sending.

join

In standby mode, double-click the [Quickly Team Building] button on the left side of the machine to launch the "Join fast Team" icon on the screen  Lights up. At this point, search for whether there is a channel around "initiate fast team". If the channel is found, adjust [main channel] and [sub-channel] to the same with the other party (including subtone), and send out a "ding" sound after joining the team successfully. If no response from the loop search for 5 times, it will automatically exit the "Join fast team" and make a "beep beep" sound.

13. Flashlight

Operate the [flashlight] key on the front of the fuselage to trigger the flashlight LED light to be lit;

Short light: Press 3 seconds: follow long light, release and turn off. (Can be used for light signal)

Constant light: Long press for 3 seconds, then make a beep to enter the long light mode

Blinking: Press stop flashlight + SOS to enter blinking mode

Exit normal light or flicker: long press [flashlight] button for 1 second to exit

14. SOS

Long press the "SOS" button for 1.5 seconds to turn on the emergency mode. The intercom will send out alarm whistle and flashlight instructions, and send out alarm signals alternately to the "main channel" and the "sub-channel" with maximum efficiency.

Mode: Send a 5-second alarm whistle every 20 seconds and wait for the rescue signal. After receiving the signal, press PTT to reply to the active channel by default.

exit



When the SOS mode is on, long press the "SOS" button for 1.5 seconds to turn off the SOS mode.

15. VOX

Support earphone VOX or bare machine VOX

Select VOX Freehold (voice-activated icon on) from the menu  Press [OK] to enter and then select the level 1-7 (display in small print and close as "OFF"). Press [OK] to confirm and return to the main interface. Voice control level 1 is the most sensitive.

16. Stopwatch

Select the stopwatch feature (stopwatch icon) from the action menu  With the countdown icon  , press [OK] to enter the function. (Maximum 999 seconds)

Press [OK] to start the timer, to start reading Numbers, press [OK] again to stop and display the stroke seconds. Press the [OK] key to restart the timing. Press the [MENU] key to end the operation and return to the main MENU.

17. Countdown

Select the countdown function (countdown icon) from the menu  With

stopwatch icon), press [OK] to enter the function. (Maximum 99 minutes)

By operating through the screen display timing time write left key stepping down timing time, 30 seconds to step into the unit, press [OK] button to confirm again to start the countdown, timing time to countdown to rang the bell, by manipulating the [OK] keyboard to confirm and close the bell, the countdown can be initiated in the process of PTT calls, and do not interrupt or suspend the countdown function at this time if the terminal is called call, the call is interrupted temporarily, countdown prompt the bell.

Note: Long press ↑ or ↓ button to quickly adjust the countdown time

23. * Vibration reminder

Vibration function version of this product is required.

By long pressing the [Ringtone] function key, the vibration function is switched on and off, and the vibration icon is displayed on the screen Light up. When the terminal is called, initiate a short vibration prompt (effective if subtone matching is required).

Note: When the electric quantity is less than 10%, the vibration function will automatically fail to save power consumption.

In standby mode, press and hold TALK button + PTT Key + [power] button to complete shutdown. Factory Settings will be restored after reboot (functions and subtones will be reset, and channel 1 will be started up)

29. * Charging instruction

To use this function, the lithium battery of this product should be selected, which supports 5V power input and charging through the Micro USB interface of the body of the intercom.

LED indicator: green means full; red means charging.

Screen icon indication: when charging power is switched on, the screen battery icon has corresponding animation indication.

Note: This product is equipped with charging protection. When in high power, it will automatically change to trickle charging mode. It is not recommended to use the walkie-talkie during charging which will reduce the battery life.

30. * Charging identification

This walkie-talkie is designed with the function of charging identification to prevent the dangerous consequence caused by the use of the dry battery by mistake. In order to ensure your safety, this walkie-talkie is guaranteed to be effective when leaving the factory and cannot be charged for ordinary batteries (except suitable lithium batteries).

Note: Please do not try to charge AA or No. 5 battery to avoid damage or injury.

31. * Compass

Walkie-talkie back clamp/standard mechanical compass, for your outdoor travel guidance to provide convenience. The back clamp is easy to disassemble. In order to avoid the interference of electronic products to the environmental magnetic field, it is recommended that you disassemble the back clamp to get more accurate direction.

32. Strong D-shaped fastening

The structure of the walkie-talkie is equipped with strong D-shaped fastening, which is suitable for outdoor environment such as mountaineering and hiking, and can be fixed and carried with quick fastening and other tools.

Please select the appropriate size tool for your convenience.

CTCSS Standard Frequency Table

The tone No.	frequency Hz	The tone No.	frequency Hz	The tone No.	frequency Hz
1	67	11	97.4	29	179.9
2	71.9	12	100	30	186.2
3	74.4	13	103.5	31	192.8
4	77	14	107.2	32	203.5
5	79.7	15	110.9	33	210.7
6	82.5	16	114.8	34	218.1
7	85.4	17	118.8	35	225.7
8	88.5	18	123	36	233.6
9	91.5	19	127.3	37	241.8
10	94.8	20	131.8	38	250.3

CTCSS No.	Positive Code	Negative Code	CTCSS No.	Positive Code	Negative Code	CTCSS No.	Positive Code	Negative Code
1	D023N	D023I	29	D174N	D174I	57	D445N	D445I
2	D025N	D025I	30	D205N	D205I	58	D464N	D464N
3	D026N	D026I	31	D223N	D223I	59	D465N	D465N
4	D031N	D031I	32	D226N	D226I	60	D466N	D466I
5	D032N	D032I	33	D243N	D243I	61	D503N	D503I
6	D043N	D043I	34	D244N	D244I	62	D506N	D506I
7	D047N	D047I	35	D245N	D245I	63	D516N	D516I
8	D051N	D051I	36	D251N	D251I	64	D532N	D532I
9	D054N	D054I	37	D261N	D261I	65	D546N	D546I
10	D065N	D065I	38	D263N	D263I	66	D565N	D565I
11	D071N	D071I	39	D265N	D265I	67	D606N	D606I
12	D072N	D072I	40	D271N	D271I	68	D612N	D612I
13	D073N	D073I	41	D306N	D306I	69	D624N	D624I
14	D074N	D074I	42	D311N	D311I	70	D627N	D627I
15	D114N	D114I	43	D315N	D315I	71	D631N	D631I
16	D115N	D115I	44	D331N	D331I	72	D632N	D632I
17	D116N	D116I	45	D343N	D343I	73	D654N	D654I
18	D125N	D125I	46	D346N	D346I	74	D662N	D662I
19	D131N	D131I	47	D351N	D351I	75	D664N	D664I
20	D132N	D132I	48	D364N	D364I	76	D703N	D703I
21	D134N	D134I	49	D365N	D365I	77	D712N	D712I
22	D143N	D143I	50	D371N	D371I	78	D723N	D723I
23	D152N	D152I	51	D411N	D411I	79	D731N	D731N
24	D155N	D155I	52	D412N	D412I	80	D732N	D732N
25	D156N	D156I	53	D413N	D413I	81	D734N	D734I
26	D162N	D162I	54	D423N	D423I	82	D743N	D743I
27	D165N	D165I	55	D431N	D431I	83	D754N	D754I
28	D172N	D172I	56	D432N	D432I			

Statement

Our Company endeavors to achieve the accuracy and completeness of this manual, if you have any question, you can contact with us, we will make a detailed answer to you in time. All the above specifications and design are subject to change without prior notice due to continuous development.

Belfone

FUJIAN BELFONE COMMUNICATIONS TECHNOLOGY CO.,LTD.

Add: A-15 Huaqiao Economic Development Zone,
Shuangyang, Luojiang, Quanzhou, Fujian, China

Tel: +86 595 28396717

Fax: +86 595 22771635

Email: overseas@belfone.com

Website: www.belfone.com



RECYCLABLE PACKAGING